



joie de vivre
HOTELS RESORTS

CHAIN CODE: JV



WELCOME TO OUR NEW ERA

FOLLOWING A \$30 MILLION REFRESH,
WE INVITE YOU TO EXPERIENCE:

- **A BOLD NEW LOOK:** Our reimagined interior includes a vibrant lobby, bar, and garden, plus 225 recently renovated guest rooms, featuring contemporary-yet-cozy furnishings and an eclectic art collection. Capture a sweeping view of the city from balcony rooms or stretch out and stay awhile in one of our Loft or Consulate Suites.
- **RELAXING ROOMS:** You'll feel right at home in our guest rooms, which offer plush beds with luxury linens, sleek bathrooms with rainshowers, 55" flat-screen smart TVs, spacious work desks, Wi-Fi, in-room coffeemakers, and mini-fridges. We also offer dog-friendly accommodations, if you prefer to travel with your furry friend.
- **DELICIOUS DINING:** Try our daily breakfast bar filled with fresh California favorites from local purveyors, or indulge in finely crafted cocktails and a wide selection of Japanese whisky, sake, and beer at The Bar at Hotel Kabuki.
- **STRESS-BUSTING AMENITIES:** Break a sweat at our 24-hour state-of-the-art Gymnasium, which offers yoga and fitness classes, or chill out at our portable meditation stations.
- **PERFECT PROXIMITY:** Revel in our prime location in the heart of San Francisco, steps from the city's best dining, shops, and sights.
- **ON-THE-GO OPTIONS:** Explore the city like a local on one of our loaner bikes. If you prefer four wheels, valet parking is also available.

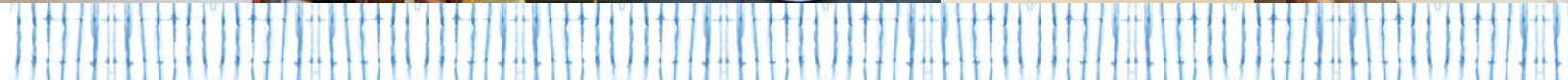



MEETINGS & EVENTS

In a city known for entrepreneurs, innovators, and disruptors, having a place to talk shop is key. Whether you're looking for a boardroom, a ballroom, or a room with a serene garden view, let us know your vision for your event, and our seasoned team will help you create the perfect program for meeting or mingling.

- 10 versatile meeting and event rooms spanning across 13,000 square feet, that can cater up to 400 people
- The Imperial Ballroom offers 4,600 square feet of pillar-free event space with soaring 13-foot ceilings
- Function space with high ceilings, natural light, and garden views
- Fresh California cuisine and globally inspired catering options
- Complimentary Wi-Fi in public spaces; high-speed internet is also available (for a fee)
- On-site audiovisual team, plus a seasoned staff of event professionals
- Discounted group room rates and hotel packages (based on availability)



FLOORPLANS

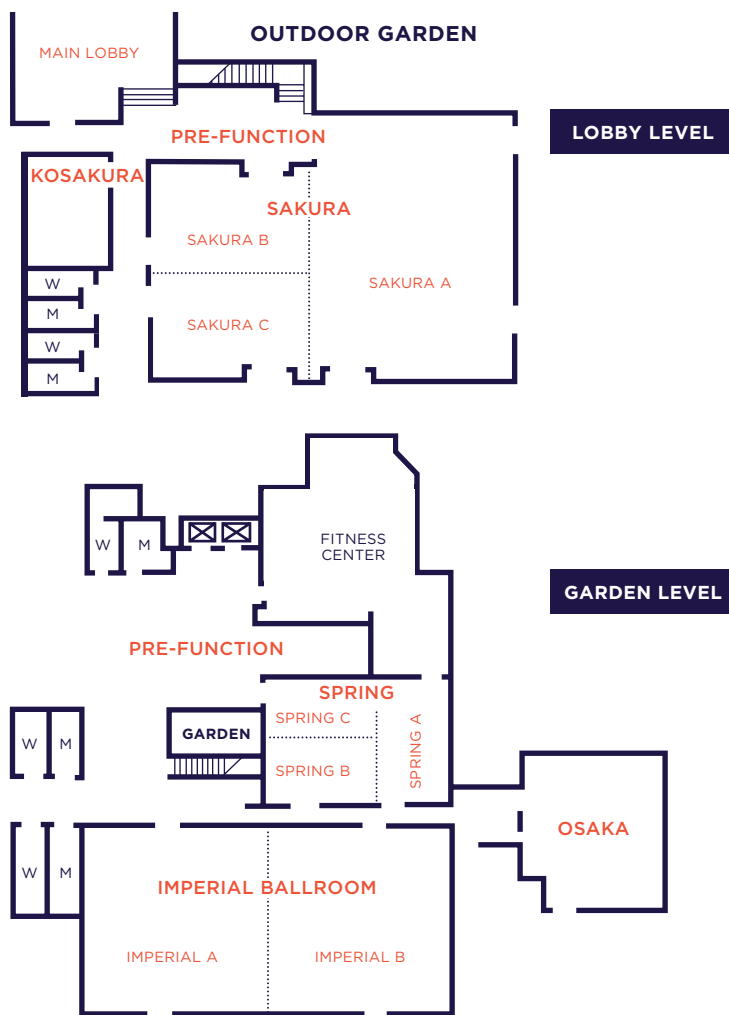

CAPACITY

FUNCTION SPACE	SIZE (ft x ft)	AREA (ft ²)	CEILING HEIGHT (ft)	THEATER	U-SHAPE	CONFERENCE	CLASSROOM	RECEPTION	BANQUET
IMPERIAL	50X92	4600	11/13	500	63	-	300	500	400
Imperial A/B	50X46	2300	11/13	250	30	-	125	250	200
OSAKA	43X36	1548	10	100	30	32	50	120	120
SPRING	49X33	1617	9	130	27	-	60	150	150
Spring A	19X33	627	9	60	21	27	30	50	50
Spring B	19X33	627	9	50	18	24	24	50	40
Spring C	19X33	627	9	50	18	24	24	50	50
SAKURA	66X58	3828	11/13	350	48	-	200	350	290
Sakura A	37X55	2146	13	180	42	45	125	200	150
Sakura B	29X21	609	11	60	24	27	60	70	50
Sakura C	29X21	609	11	60	24	27	60	70	50
KOSAKURA	14X25	350	10	-	-	12	-	-	-